

BUILDBASE STOCK GUIDE: LINTELS

**BIGGER LINTELS
RANGE IN
STOCK NOW**



buildbase.co.uk

BUILDBASE
BUILDING & TIMBER SUPPLIES

AN INTRODUCTION TO LINTELS

At Buildbase we work with quality concrete and steel lintels suppliers Keystone Lintels, Birtley Steel Lintels and Supreme Concrete to provide a comprehensive range for all projects, stocked in a variety of lengths.

Lintels are available for new builds, residential and commercial refurbishments, with heavy duty variants now available to support extra loads or wider openings.

Branches will stock either Birtley Steel Lintels or Keystone Lintels.

Prestressed concrete lintels play a pivotal role in any building's structural integrity typically used for window and door openings. They can accept a wide range of surface finishes without special preparation and come in a variety sizes and loadings. This makes concrete lintels reliable and durable with a lower construction cost, fewer joints and a high strength to section ratio.

Steel lintels are galvanized to protect against premature rust and corrosion and meet the Thermal Performance requirements of all UK Building Regulations. Compared to their concrete counterparts, steel lintels are lighter and therefore easier to handle on site, this alongside its strength, durability and ability to be recycled make it truly compatible with long term sustainable development.

**MORE CHOICE,
MORE SIZES AND
GUARANTEED
STOCK FOR WHEN
YOU NEED IT!**



CAVITY WALL LINTELS

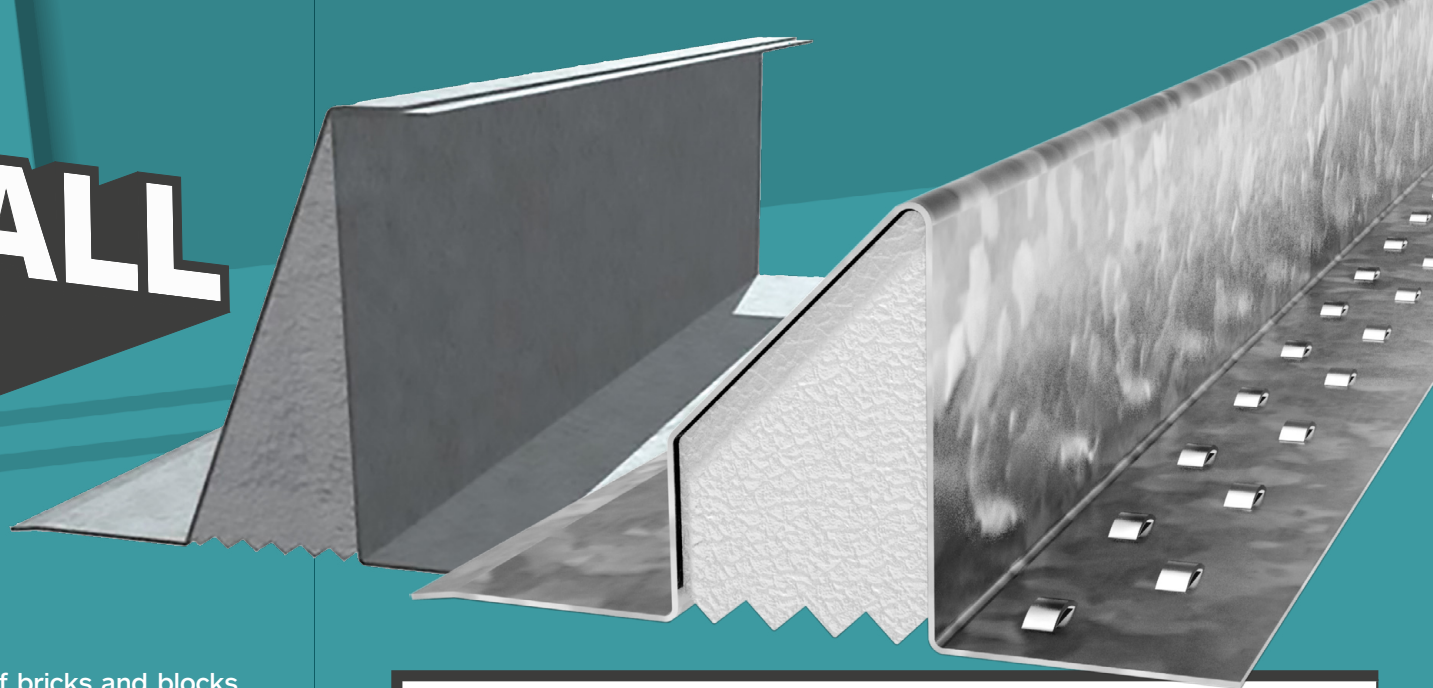

Cavity wall lintels are designed for use when two layers of bricks and blocks or 'skins' are used to construct a space or cavity between the structure. The in-built foam or polystyrene insulation helps to retain warmth through insulation and reduces condensation.

Our key suppliers are Birtley Steel Lintels and Keystone Lintels. All of our steel lintels are galvanized to protect against premature rust and corrosion and meet the Thermal Performance requirements of all UK Building Regulations.

The NHBC (National House Building Council) recommend a damp-proof course (DPC) or cavity tray should be installed over all openings in external cavity walls

Buildbase has a large range of standard cavity lintels available in a variety of widths from 70mm to 165mm, with lengths from 900mm to 3900mm.

For thicker steel and when a lintel with a longer span is required, Buildbase has a range of medium and heavy duty lintels for 90-105mm cavity widths stocked in lengths from 1200mm to 4800mm.

Branches will stock either Birtley Steel Lintels or Keystone Lintels.

Cavity Wall Lintels (70-85mm Cavity) stocked in:

BIRTLEY STEEL LINTELS CB70	PRODUCT CODE	KEYSTONE LINTELS S/K-70	PRODUCT CODE
1200mm	2580695	1200mm	2541312
1500mm	2580705	1500mm	2541316
1800mm	2580715	1800mm	2541320
2100mm	2580725	2100mm	2541324
2400mm	2580735	2400mm	2541328
2700mm	2580745	2700mm	2541332

Cavity Wall Lintels (90-105mm Cavity) stocked in:

BIRTLEY STEEL LINTELS CB90	PRODUCT CODE	KEYSTONE LINTELS S/K-90	PRODUCT CODE
900mm	2581045	900mm	2541404
1050mm	2581050	1050mm	2541406
1200mm	2581055	1200mm	2541412
1350mm	2581060	1350mm	2541414
1500mm	2581065	1500mm	2541416
1650mm	2581070	1650mm	2541480
1800mm	2581075	1800mm	2541482
1950mm	2581080	1950mm	2541422
2100mm	2581085	2100mm	2541424
2250mm	2581090	2250mm	2541426
2400mm	2581095	2400mm	2541428
2550mm	2581100	2550mm	2541430
2700mm	2581105	2700mm	2541432
2850mm	2581110	2850mm	2541434
3000mm	2581115	3000mm	2541436
3300mm	2581120	3300mm	2541502
3600mm	2581125	3600mm	2541506
3900mm	2581130	3900mm	2541510

**MEDIUM AND HEAVY DUTY
LINTELS IN STOCK**



CAVITY WALL LINTELS

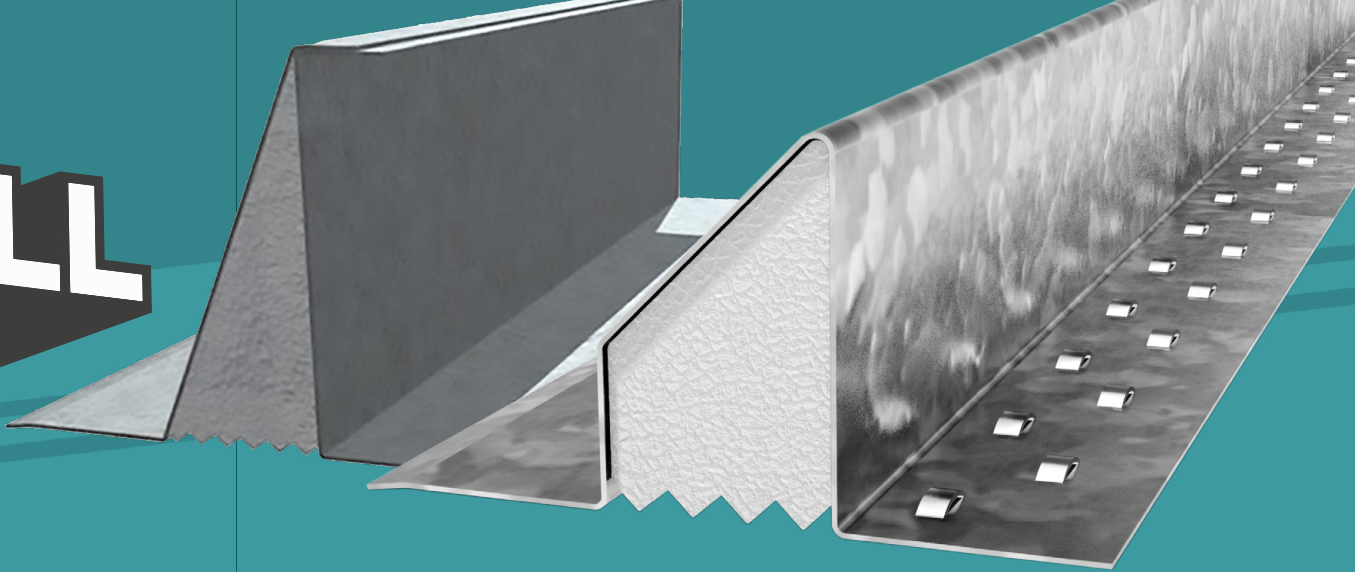

Cavity Wall Lintels (110-125mm Cavity) stocked in:

BIRTLEY STEEL LINTELS CB110	PRODUCT CODE	KEystone LINTELS S/K-110	PRODUCT CODE
1050mm	2585661	1050mm	2540941
1200mm	2585662	1200mm	2540942
1350mm	2585663	1350mm	2540943
1500mm	2585664	1500mm	2540944
1650mm	2585665	1650mm	2540945
1800mm	2585666	1800mm	2540946
1950mm	2585667	1950mm	2540947
2100mm	2585668	2100mm	2541424
2250mm	2585669	2250mm	2585669
2400mm	2585670	2400mm	2540949
2550mm	2580909	2550mm	2540950
2700mm	2585672	2700mm	2540952
2850mm	2580910	2850mm	2540971

Cavity Wall Lintels (150-165mm Cavity) stocked in:

BIRTLEY STEEL LINTELS CB150	PRODUCT CODE	KEystone LINTELS S/K-150	PRODUCT CODE
1500mm	25856371	1500mm	2540067
1650mm	2585638	1650mm	2540062
1800mm	2585640	1800mm	2540070
2100mm	2585644	2100mm	2540060
2400mm	2585648	2400mm	2540064

Heavy Duty Cavity Wall Lintels (90-105mm Cavity) stocked in:

BIRTLEY STEEL LINTELS HD90	PRODUCT CODE	KEystone LINTEL HD/K-90	PRODUCT CODE
3300mm	2586660	3300mm	2543179
3600mm	2586661	3600mm	2543181
3900mm	2586662	3900mm	2543183
4200mm	2586663	4200mm	2543186
4500mm	2586664	4500mm	2541518
4800mm	2586665	4800mm	2541522

Standard/Medium Duty Cavity Wall Lintels (90-105mm Cavity) stocked in:

BIRTLEY STEEL LINTELS CB90HD	PRODUCT CODE	KEystone LINTELS HD/K-90	PRODUCT CODE
1200mm	2581150	1200mm	2543158
1500mm	2581160	1500mm	2543160
1650mm	2581165	1650mm	2543161
1800mm	2581170	1800mm	2543162
1950mm	2581175	1950mm	2543165
2100mm	2581180	2100mm	2543170
2250mm	2581185	2250mm	2543171
2550mm	2581195	2550mm	2543172
2700mm	2581200	2700mm	2543173
2850mm	2581205	2850mm	2543176
3000mm	2581210	3000mm	2543177

**MEDIUM AND HEAVY DUTY
LINTELS IN STOCK**



SOLID WALL BOX LINTELS



Box lintels are used for solid wall construction, with the 100mm ranges used for single skin internal walls and the 200mm ranges used for double skins, typically external walls, with no cavity.

The lintel is designed to carry the full load of wet masonry as soon as it is installed but must have a minimum end bearing of 150mm each side of the opening and be bedded on mortar with all perpendicular joints filled with mortar.

Box lintels are available in two options to support 100mm wide walls with lengths from 1200mm to 3600mm, and 200-215mm wide walls with lengths from 1200mm to 4800mm.

The box lintel is galvanised to protect the steel from premature rust and corrosion and has perforations along its length acting as a plaster key and can be insulated if required.

Branches will stock either Birtley Steel Lintels or Keystone Lintels.

BIRTLEY STEEL LINTELS SB100	PRODUCT CODE	KEYSTONE LINTELS BOX K/100	PRODUCT CODE
1200mm	2583970	1200mm	2540405
1500mm	2583980	1500mm	2540407
1800mm	2583990	1800mm	2540409
2100mm	2584000	2100mm	2540411
2400mm	2584010	2400mm	2540413
2700mm	2584020	2700mm	2540415
3000mm	2584030	3000mm	2540417
3600mm	2584040	3600mm	2540421
BIRTLEY STEEL LINTELS SBL200	PRODUCT CODE	KEYSTONE LINTELS BOX K/200	PRODUCT CODE
1200mm	2584445	1200mm	2540605
1500mm	2584455	1500mm	2540607
1800mm	2584465	1800mm	2540609
2100mm	2584475	2100mm	2540611
2400mm	2584485	2400mm	2540613
2700mm	2584495	2700mm	2540615
4800mm	2584535	4800mm	2540629

**MORE DEPTH AND
BREADTH OF SIZES**



SINGLE LEAF LINTELS

Constructed from galvanised steel, single leaf lintels are used to support single leaf walls or the external openings (the outer leaf) of a cavity wall, adding strength to the construction.

Single leaf lintels are suitable for faced brick or block walls and can be used for meter reading boxes through to heavier applications. Lintels over 1500mm must be propped until masonry is fully loaded and cured.

Branches will stock either Birtley Steel Lintels or Keystone Lintels.

BIRTLEY STEEL LINTELS LA	PRODUCT CODE
900mm	2583585
1200mm	2583595
1350mm	2583600
1500mm	2583605
1650mm	2583610
1800mm	2583615
2100mm	2583625
2400mm	2583635
2700mm	2583645

KEYSTONE LINTELS SB/K	PRODUCT CODE
900mm	2540103
1200mm	2540105
1350mm	2540106
1500mm	2540107
1650mm	2540108
1800mm	2540109
2100mm	2540111
2400mm	2540113
2700mm	2540115

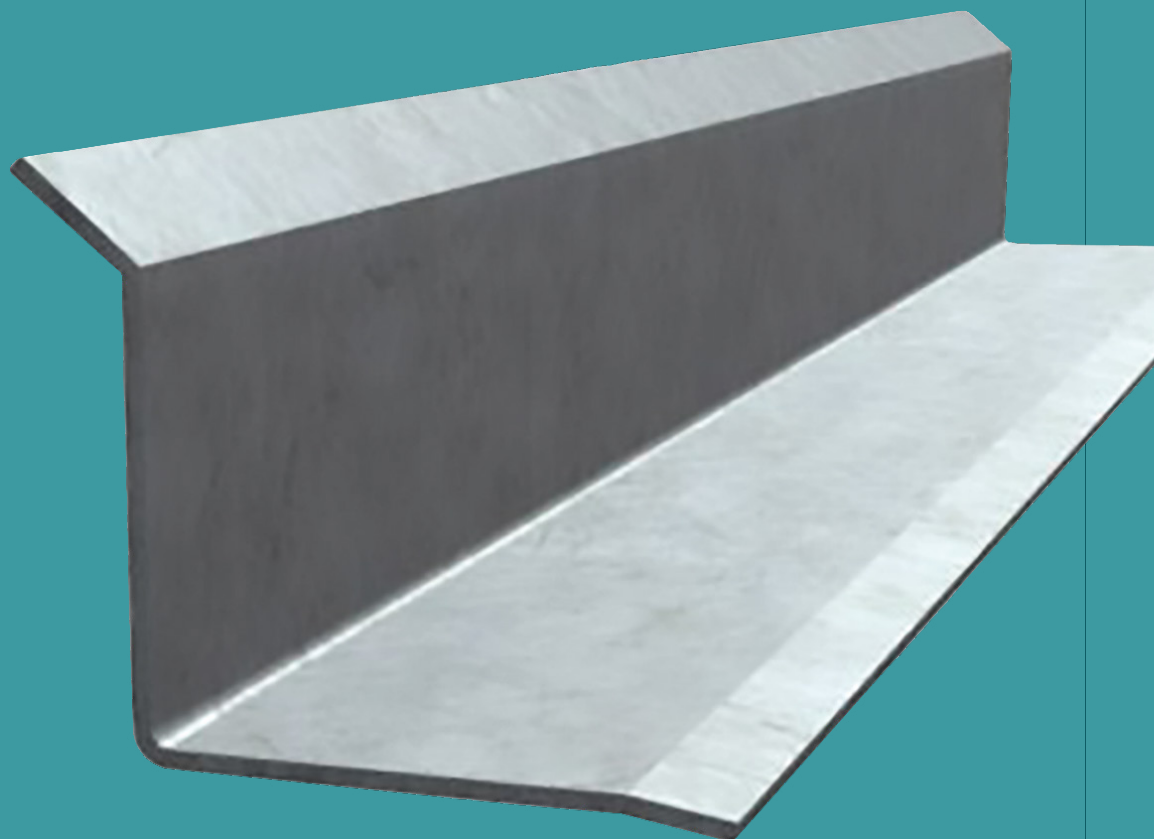

**NEXT DAY DELIVERY
AVAILABLE ON ALL LINTELS**



CONCRETE LINTELS



Prestressed concrete lintels are one of the most reliable, durable and widely used in the construction industry, boasting a number of benefits including lower construction cost, fewer joints and a high strength to section ratio.

Supreme prestressed concrete lintels have been awarded a BSI Kitemark, are manufactured with a texture finished and feature Supreme's superior concrete technology to match the lintel to a multitude of frames.

Prestressed lintels have high-tension steel wires running through the middle. The lintels have excellent thermal properties and are less susceptible to moisture and chemical corrosion.

The lintel should be installed with a minimum end bearing of 150mm and unlike steel lintels, a concrete lintel is often used in visible areas and painted if required.

Supreme Prestressed Concrete Lintels stocked in sizes from 600mm to 3000mm:

SUPREME R15	PRODUCT CODE
600x100x140mm	2500101
900x100x140mm	2500103
1050x100x140mm	2500104
1200x100x140mm	2500105
1350x100x140mm	2500106
1500x100x140mm	2500107
1800x100x140mm	2500109
2100x100x140mm	2500110
2400x100x140mm	2500111
2700x100x140mm	2500112
3000x100x140mm	2500113
SUPREME R22	PRODUCT CODE
1500x100x215mm	2500127
1800x100x215mm	2500129
2100x100x215mm	2500130
SUPREME R21	PRODUCT CODE
1500x140x215mm	2500177
SUPREME P100	PRODUCT CODE
600x65x100mm	2500001
900x65x100mm	2500003
1050x65x100mm	2500004
1200x65x100mm	2500005
1500x65x100mm	2500007
1800x65x100mm	2500009
2100x65x100mm	2500010
2400x65x100mm	2500011
2700x65x100mm	2500012
3000x65x100mm	2500013
SUPREME P220	PRODUCT CODE
1200x65x215mm	2500065
1500x65x215mm	2500067

**LENGTHS UP TO 3000MM
NOW IN STOCK**



PADSTONES



Supreme padstones are high strength dense concrete blocks designed to support the weight of load-bearing lintels whose ends rest on the padstone. The concrete used in the manufacturing of the padstone conforms to a compressive strength class C40/50.

Concrete padstones are a vital part of construction as they designed not to be crushed like regular blockwork when subjected to the pressure of the steel or concrete lintel and the weight above.

SIZE	PRODUCT CODE
215 x 140 x 102mm	2305280
300 x 140 x 102mm	2305285
440 x 140 x 102mm	23052851
215 x 140 x 215mm	23052852
440 x 140 x 215mm	2305290
215 x 215 x 102mm	2305286
440 x 215 x 102mm	2305287

**CONTACT US WITH
ANY LINTEL ENQUIRY**



SPECIAL ORDERS

At Buildbase we have access to a wide range of lintels and accessories suitable for all projects.

Speak to your local branch team for all your lintel needs.

- ◆ Timber frame lintels
- ◆ Eaves lintels
- ◆ Bespoke designs e.g. arch lintels
- ◆ Stainless steel lintels
- ◆ Cavity Trays
- ◆ DPC

BEFORE ORDERING A LINTEL...

Check with the project's structural engineer to advise on the best lintel for the job



Buy Online

at www.buildbase.co.uk



Supreme

Birtley

Keystone
LINTELS